

## COMPLAINT

SECONDARY COMPLAINT

## Burned clutches and bands

- Poor shift quality

## CAUSE

Wear at the piston pin bore due to repeated reciprocation.

## CORRECTION

The Sonnax patented pinless design with dual seals stabilizes the piston in the bore and provides improved sealing characteristics. Use of this part eliminates the need for the pins.

## Pinless Accumulator Pistons

For 1-2 or 3-4 accumulator bore

### 77998-03K

- 1 Pinless Accumulator Piston
- 1 D-Ring
- 1 Teflon® Seal
- 2 Steel Balls

### 77998-02K

- 1 Pinless Accumulator Piston

### 77998-04K

- 1 Pinless Accumulator Piston
- 2 Steel Balls

**Note:** U.S. Patent No. 6,899,211

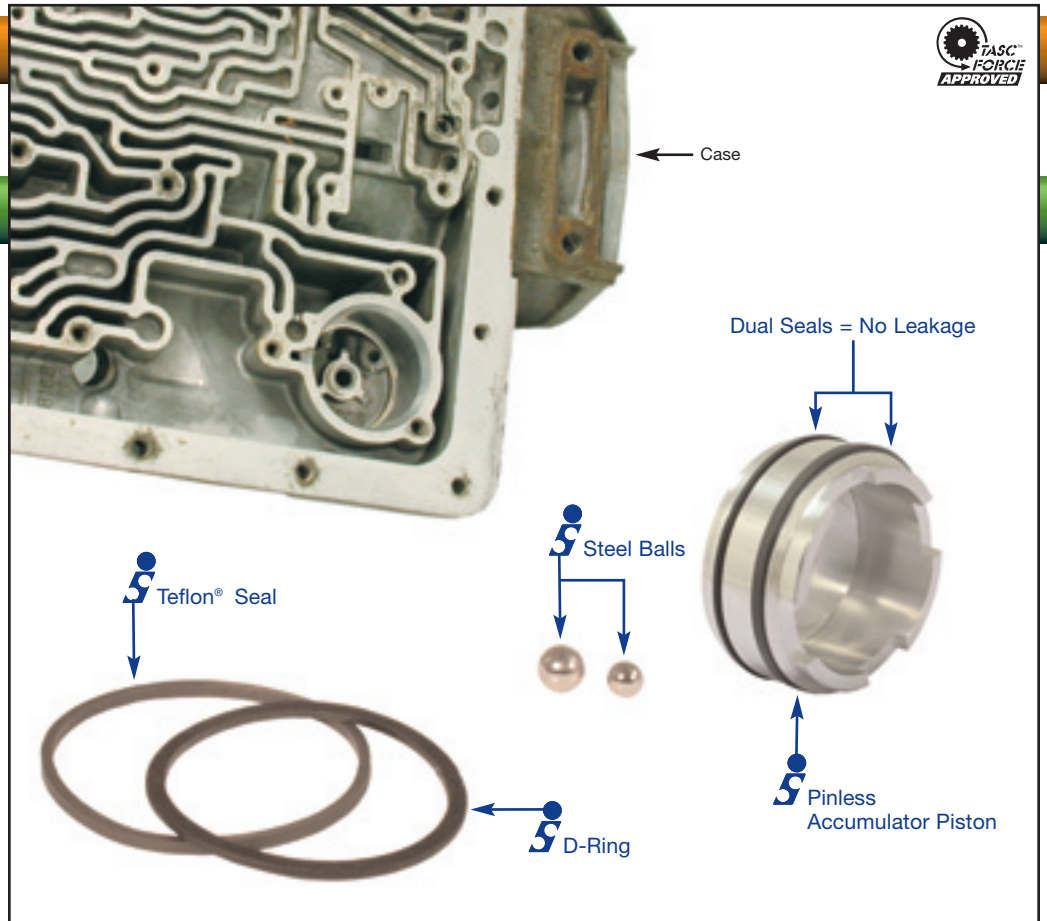

### Sonnax Part Summary

In 4L60 & 4L60-E units it is common to have poor shift quality, burned bands or clutches due to accumulator piston wear. Repeated reciprocation of the accumulator piston causes wear at the piston pin bore interface. After this wear reaches a critical point, fluid loss through the piston pin bore cannot be compensated due to lack of pump volume. In addition, the piston can get cocked and gall the accumulator bore due to the pin bore wear or the spring bottoming out. Sonnax now offers three versions of a dual-seal, pinless accumulator piston kit, 77998-02K, 77998-03K and 77998-04K, to prevent the above conditions.

### Features & Benefits

- Dual seals stabilize and completely seal the bore and provide a tight seal even after thousands of cycles.
- Pinless design eliminates the possibility of pin leakage and the additional length stabilizes the piston to prevent piston cocking.
- Steel balls included for plugging existing pin bore in case or cover.