

## COMPLAINT

SECONDARY COMPLAINTS

## CAUSE

Wear at the TCC regulator valve bore reduces apply pressure or TCC solenoid is damaged from valve contact.

## CORRECTION

This kit includes a wear-resistant sleeve, modified valve and spring to re-establish proper apply pressure to the torque converter clutch, and prevents damage to the TCC PWM solenoid.

## TCC Regulator Valve and Sleeve Kit

### 55211-04K

- 1 Sleeve
- 1 Valve
- 2 Retaining Clips
- 1 Spring
- 1 Solenoid Protector



### F-55211-TL4

- 1 Reamer Jig
- 1 Guide Pin
- 1 Reamer



Also available

### 55211-01K

AFL Valve & Sleeve Kit



### 55211-11K

Reverse Lockout Valve and Sleeve Kit



### F-55211-TL

Tool Kit for both 55211-01K and 55211-11K



## TCC slip and ratio codes

- Transmission and converter overheat
- Delayed or no reverse
- Reverse lockout valve sticking

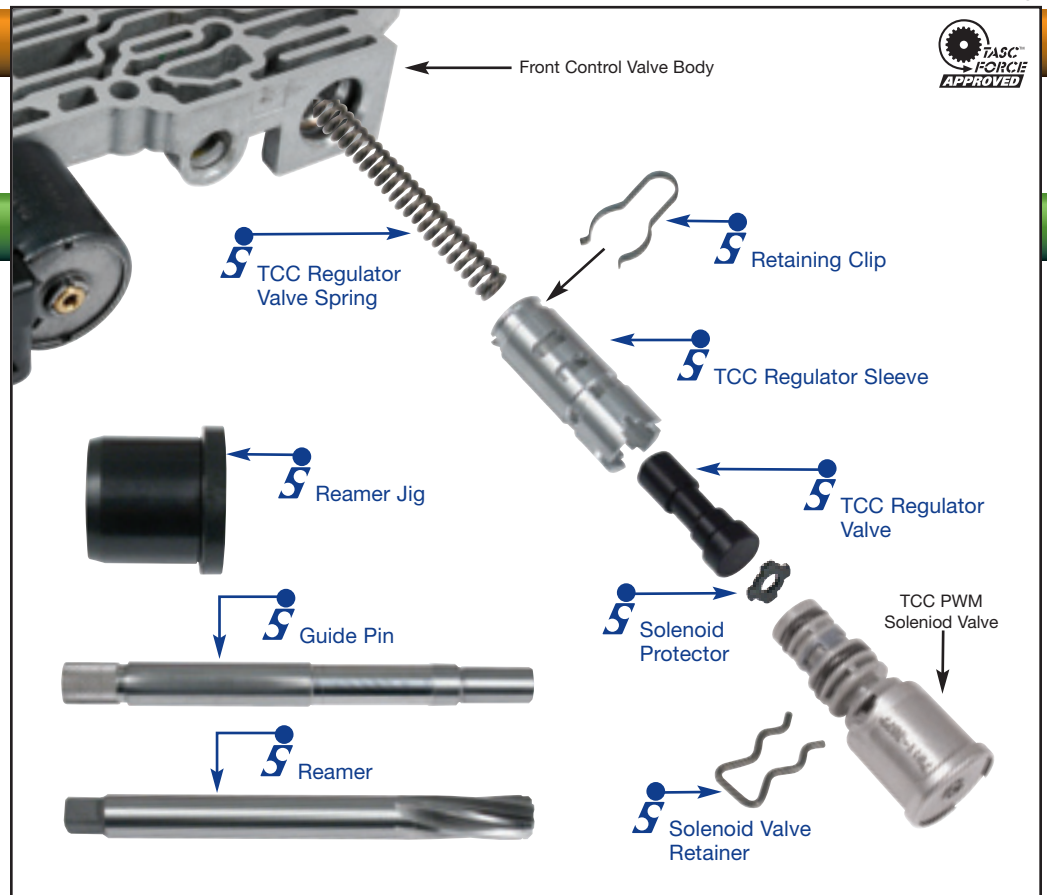

### Sonnax Part Summary

When the TCC PWM solenoid is energized and TCC signal fluid pressure is present, it strokes the TCC regulator valve and regulates line pressure into the converter clutch apply passage. Due to the pulse width modulation of the solenoid, the regulator valve is continuously oscillating. Excessive wear at the large spool diameter can prevent proper valve movement, causing no TCC, slips or soft apply. Excessive wear at the balance end of the bore can lead to harsh apply. Additionally, the OEM valve stops against the TCC PWM solenoid screen, resulting in damage or breakage. Debris from the broken screen can lodge at the reverse lockout valve, resulting in no reverse. The Sonnax TCC regulator valve and sleeve kit includes a highly wear-resistant sleeve, modified valve and spring to restore proper converter clutch apply pressure. A solenoid protector is also included to eliminate damage to the solenoid screen. The valve bore must be reamed to accommodate the sleeve.

### Features & Benefits

- Highly wear resistant sleeve provides significantly more valve support to reduce leakage and prevent wear.
- Anodized aluminum valve resists wear to prevent leakage.
- Modified replacement spring restores proper pressure with the undersized valve.
- Solenoid protector eliminates solenoid screen damage.