

COMPLAINT

SECONDARY COMPLAINTS

Loss of reverse, TCC overheat, Burned reverse clutch

- Burned low and reverse clutch • Transmission damage

CAUSE

Wear at the reverse lockout valve can allow TCC Signal and reverse oil to cross leak or leak to exhaust.

CORRECTION

This kit includes a wear-resistant sleeve, modified valve and spring to establish proper pressure, and prevent leakage of TCC signal or reverse oil at the worn bore.

Reverse Lockout Kit

55211-11K

- 1 Reverse Lockout Valve
- 1 Reverse Lockout Sleeve
- 1 Reverse Lockout Spring



F-55211-TL

- 1 Reamer Jig
- 1 Guide Pin
- 1 Roughing Reamer
- 1 Finish Reamer



Note: This tool kit is used for installing both 55211-11K & 55211-01K.

Also available

55211-01K

AFL Valve & Sleeve Kit



Note: Use tool kit above F-55211-TL.

55211-04K

TCC Regulator Valve and Sleeve Kit



F-55211-TL4

Tool Kit for 55211-04K

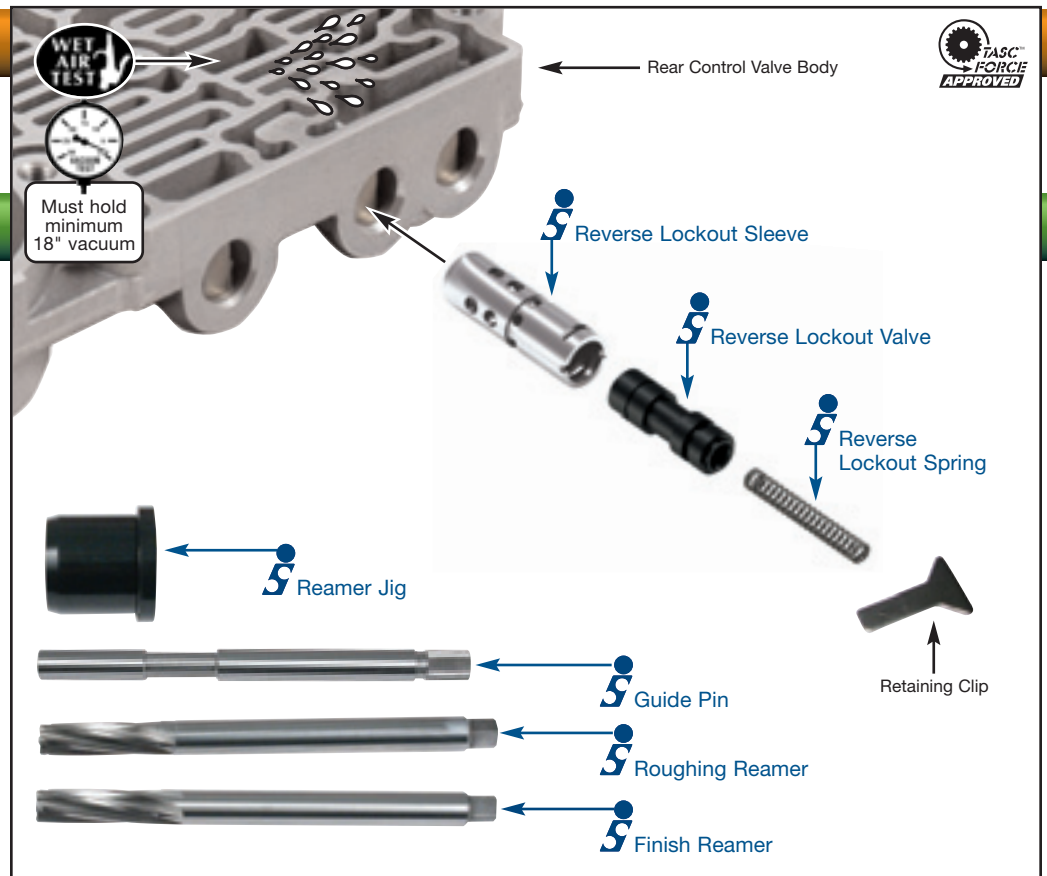

Part Summary:

When in reverse gear, the reverse lockout valve directs reverse fluid into the reverse lockout fluid (RLO) circuit to apply the reverse clutch and low/reverse clutch. Wear at the inboard spool bore can allow reverse fluid pressure to enter the TCC signal circuit and partially stroke the TCC regulator valve. This can result in TCC overheat and loss of reverse. The reverse lockout valve also responds to TCC signal fluid pressure to block fluid from entering the reverse lockout circuit, thus preventing the reverse clutch and low/reverse clutch from applying while the vehicle is moving forward. If there is excessive bore leakage, TCC signal can cross leak into the RLO circuit, and begin to apply and burn the reverse clutches or cause transmission damage. This Sonnax sleeve, valve and spring kit eliminates bore wear, and reestablishes the correct hydraulic pressures to prevent these problems.

Features & Benefits:

- Highly wear-resistant sleeve provides significantly more valve support to reduce leakage and prevent wear.
- Anodized aluminum valve resists wear to prevent leakage.
- F-55211-TL tool kit already available and also services the 55211-01K AFL Valve and Sleeve Kit.