

## COMPLAINT

SECONDARY COMPLAINT

## Harsh, bumpy or flare shifts

- Slipping gears

## CAUSE

Wear at the 1-2/4-5, 2-3 and/or 3-4 overlap control valve sleeves allows modulating oil pressure to exhaust.

## CORRECTION

These modulating sleeves position the valve for proper clutch feed. Sleeve kits correct the wear condition and restore control of clutch pressure apply or exhaust.

## Overlap Control Valve Sleeve Kits

**68942-05K** Overlap Control Sleeve Kit  
3 Sleeves (1 for each location)  
3 O-Rings

Also available separately

**68942-02** 1-2/4-5 Overlap Control Sleeve

**68942-03** 2-3 Overlap Control Sleeve

**68942-04** 3-4 Overlap Control Sleeve

Each kit includes the following

- 1 Sleeve
- 1 O-Ring

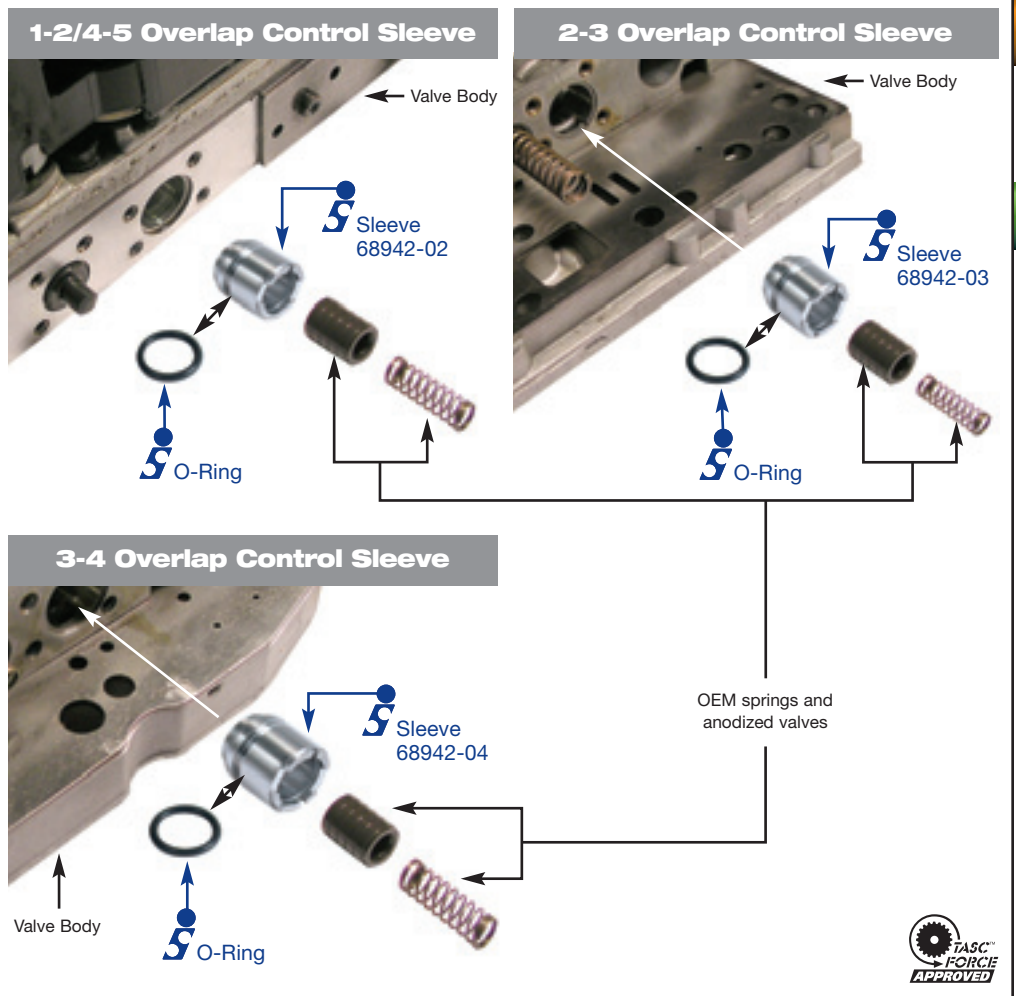

### Sonnax Part Summary

Continuous plunger valve oscillation causes wear at the 1-2/4-5, 2-3 and/or 3-4 overlap control valve sleeves, allowing modulated oil pressure to exhaust or oppose the shift and create numerous shift complaints. The highly wear-resistant Sonnax replacement sleeves restore necessary hydraulic control tolerances, and have external o-rings to provide additional positive sealing in the bore. The OEM springs and anodized valves can be reused.

### Features & Benefits

- Highly wear-resistant sleeves restore hydraulic control.
- External o-rings provide additional positive sealing in the bore.
- The OEM springs and anodized valves can be reused.
- End-face grooves aid in easy sleeve identification.

